



**CALL FOR ENTRIES
NEWPORT BEACH CIVIC CENTER INVITATIONAL SCULPTURE EXHIBITION
Phase X**

1000 Avocado Avenue, Newport Beach, CA 92660

DATE ISSUED: August 1, 2025

DEADLINE TO APPLY: September 29, 2025 – NO APPLICATION FEE REQUIRED

The City of Newport Beach (City) announces a call for entries for Phase X of its ongoing Sculpture Exhibition to further activate the splendor of its Civic Center Park. **Up to ten artworks may be selected and showcased for three years** in the 14-acre, ocean-view site designed by renowned landscape architect Peter Walker as an intended sculpture garden.

The Civic Center is the heart of Newport Beach - home to City Hall, administrative offices, and the spectacular Central Library building. And the Park welcomes residents and visitors year-round for free concerts on the lawn, art shows, docent-led sculpture tours, visits to the dog park, or leisurely trail walks among the environmentally-friendly native plant life.

The Sculpture Exhibition transforms Civic Center Park into a “museum without walls,” constantly evolving as new, bold contemporary works from world-class artists rotate through, delighting and enriching park visitors. Artists, private collectors, galleries, and museums/non-profit institutions are invited to submit artworks for consideration to be installed from June 2026 to June 2029.



Looking west from the pedestrian bridge which connects the north and south portions of the park.

For information about Civic Center Park

<https://www.newportbeachca.gov/government/departments/library-services/cultural-arts/sculpture-in-civic-center-park-exhibition>

TO APPLY:

Artists, Private Collectors, Galleries, Museums, and Non-Profit Organizations may all submit for consideration; with a limit of **only one (1) finished, unique, available artwork per artist**. All submissions must be made online using the Call for Entry (aka CaFE) platform. [Visit here](#) for details on how to apply. **There is no application fee.**

ELIGIBILITY:

All applicants must be over the age of 18. This call is open to all professional artists and artist teams, private collectors, galleries, and museums/non-profit organizations, in any country. **Submitted works, however, must be complete, in installation-ready condition, and physically located in the**

United States at the time of submission. The exhibition budget does not allow for the costs of overseas transportation.

Submissions of proposals, renderings, miniatures, general work portfolios, and other unfinished work states, or works mass-produced as part of a series, will be marked ineligible and not presented to the jury.

Submitted works must be available for delivery to the Newport Beach Civic Center Park site **during the period of June 1-26, 2026 for installation**, and artist must be able to arrange for retrieval of the work at its **deinstallation in June 2029, exact dates TBD.**

SUBMISSION REQUIREMENTS:

To apply: The application at CaFE must be completed, and all required supporting documents and media uploaded, by Monday, September 29th, 2025, at 10:59 pm Pacific/11:59pm Mountain. Please note the time, as CaFE is always set to Mountain Time and this cannot be changed.

Applicants are STRONGLY urged to submit early to allow for dealing with any technology challenges. Late submissions will NOT be accepted. There will be NO extension of the submission deadline.

APPLICATION MATERIALS:

- Title of artwork
- Very brief description of artwork (25-word maximum)
- Practical physical description of the piece including: materials, accurate dimensions, weight, any special installation needs, other unique features
- Estimated value of artwork
- Current location of artwork
- If relevant, Collection of [insert name here] OR Courtesy of [insert name here]
- List of previous exhibition locations for the submitted work, if any
- Has the proposed artwork been installed in an outdoor, public setting before? If not, how will you prepare the artwork for the outdoor, public installation at the Civic Center Park? Moisture, intense sunlight, and proximity to the salty ocean can all cause significant wear over three years
- Why is the submitted artwork appropriate for the Civic Center Park?
- What is your relevant public art experience?

- Preliminary Budget to include: 1) Estimated round-trip transportation cost 2) Insurance cost 3) Artist's fee. **Budget total must not exceed honorarium of \$7,500.**

- Resume/curriculum vitae (no more than two pages) including name, mailing address, phone number(s), email and website (if applicable), and relevant professional references* (*optional)

- Between two (2) and four (4) images of the submitted artwork. Pictures should, as much as possible, show the work in focus and good, even light with minimal background distractions. At least one picture should capture the piece in full, and at least one should provide close-up detail. **These images will be the primary focus for Selection Committee discussion and will represent your work in any public polling, so quality and clarity is imperative. Also, any images not of the submitted piece (e.g. other works by the artist,) will be removed from consideration.**

- **Artwork must arrive in the same condition as seen in submitted images.** Artwork delivered that differs in any way from the submitted images may be subject to rejection and automatic termination of the Memorandum of Understanding & Loan Agreement at the sole discretion of the City of Newport Beach or its project contractor.

- Review and approval of the sample MEMORANDUM OF UNDERSTANDING & LOAN AGREEMENT. Your application submission indicates you have read, understand, and are willing to accept the terms of the Memorandum of Understanding & Loan Agreement if selected to participate in the exhibition.

- The Memorandum of Understanding & Loan Agreement in this RFP is subject to change without notice; only the Agreement issued to the artist upon selection of their work will be binding.

ADDITIONAL INFORMATION:

- Applications will only be accepted online through CaFE. Do not send applications directly to Arts Orange County or the City of Newport Beach.
- If artists are applying as a team, include resumes for all team members.
- The City of Newport Beach reserves the right to reject any or all submissions and decline to award contracts for this project.

- The City of Newport Beach reserves the right to re-consider submissions initially ruled ineligible at its discretion.
- All artists who submit their materials for review will receive notification of the results of the selection process, including the identification of the selected artists.
- All information contained herein does not constitute an expressed or implied contract.
- Works selected must remain for the entire duration of the exhibition and be sturdy enough to withstand the site's significant climactic environments – cold, heat and humidity, rain, salt air, wind, etc.
- Successful applicants will be responsible for transporting their artworks to and from the site according to the contract schedule. At the site, the City will coordinate and pay for professional installation and de-installation services for all selected artworks.
- The City has retained Arts Orange County (ArtsOC), the nonprofit countywide arts council, to provide professional coordination services for the Sculpture Exhibition. The professional art installation service Art Installation Remedies, Inc., along with public art consultant Joe Lewis, will assist ArtsOC with the project.

CALENDAR (*Dates Subject to Change)

August 1, 2025	Open Applications
September 29, 2025	Submission Deadline
September 30 – October 5, 2025	Jury Review
October 9, 2025	Arts Commission Regular Meeting: In consultation with outside jurors and program consultants, along with public comment, the Arts Commission approves a slate of eligible works to be voted on by public survey
October 15, 2025	Eligible works presented to the public to select 10 Recommended Finalists and 3-5 Alternates
December 5, 2025	CLOSE Public Survey
December 11, 2025	Arts Commission Regular Meeting: Presentation of Public survey rankings
December 12, 2025	ArtsOC advises submitting artists of their status. Recommended Finalists must undergo review of eligibility/availability of the work and an initial installation consultation, along with completion of a W9 form in case an honorarium is awarded
January 13, 2026	City Council Regular Meeting: City Arts Commission Recommendations are presented for final review, public comment, and approval
January 14, 2026	Selected artists officially notified
February 17, 2026	Official city contracts sent to selected artists via FedEx. Installation dates scheduled and sites prepared. Media information collected from artists for press and marketing. Media and promotional materials developed.
June 1, 2026	Confirm that all artist contracts are received and delivered to city.
June 1-27, 2026	Installation of artwork
June 27, 2026	Opening Reception Luncheon

SELECTION CRITERIA:

The City seeks a well-balanced exhibit of Public Art emphasizing a variety of styles, types, and sizes; and a diverse pool of artists. The City will determine specific installation sites for artworks within the Park grounds. Site locations are subject to change and the City reserves the right to relocate exhibition sculptures within Civic Center Park without notice and at its sole discretion.

- **Artistic Merit:** Artists shall have substantial professional qualifications, to be reflected in high-quality submissions which demonstrate originality and artistic excellence.
 - Artwork must be the original work of the identified artist or artists. Artworks, when installed, will be readily visible from the interpretive trails. Artworks should be suitable for viewing from all angles.
 - Artworks shall be appropriate for audiences of all ages.
- **Durability:** The City will consider only artwork made of high-quality materials which can withstand the natural elements of coastal Southern California for a minimum of three years. Consideration will be given to structural and surface integrity, protection against theft and vandalism, and minimal maintenance requirements.
- **Meets Minimum Requirements:** **At the time of submission**, artworks must be located in the United States, finished and installation-ready, and available for the duration of the exhibition period, available for delivery during the pre-determined installation period of **June 1-26, 2026**.
 - In most cases, the artworks will be installed on a concrete pad raised approximately 4" above ground or affixed to concrete footings flush with the ground. Depending upon the nature of their design, some works may be installed in such a manner that they come into direct contact with the ground.
 - **If there are any special requirements for installing the artwork (e.g. requires a raised plinth, cannot touch the ground, etc.), these must be explained on the submission form.** Similarly, if any images of the artwork in the submission display bases, plinths, or other structural

elements associated with display or installation, the submission must explain whether these will be provided with the artwork, and their dimensions and weight also provided.

- **Site Responsiveness:** Artwork should be appropriate in scale, material, and content for the immediate, general, social, and physical environments to which they relate. Artworks will be installed in unsupervised areas and **must not exhibit unsafe conditions or factors that may bear on public liability**, as members of the public may come into contact with the works.

Artworks which incorporate sustainable strategies, demonstrate green processes or utilize green design, materials theories, and techniques are welcome, but not required.

SELECTION PROCESS:

A Selection Committee consisting of seven (7) Newport Beach Arts Commissioners and two (2) local arts professionals will be responsible for determining which submissions meet standards of initial eligibility. They will do this at a public meeting of the City Arts Commission.

Works determined to be eligible will be presented to City of Newport Beach residents through a public, online survey. Results of the survey are non-binding but will factor into the Committee's decision-making at a follow-up public meeting. **Ten (10) finalists and three to five (3-5) alternates will be selected.**

Finalists and alternates will be notified of their status, but neither are guaranteed selection. Final selections are contingent upon passing a qualification review and final approval by the Newport Beach City Council.

HONORARIUM:

Selected artists will receive an honorarium of \$7,500 in exchange for a three-year loan of their artwork. **No other fees or expense reimbursements are offered.** Honorarium shall be used to cover round-trip transportation of the artwork to and from the exhibition site, structural engineering documents (if required,) any insurance needed or desired for artwork transport and display, and for the cost of on-site availability during installation and removal. Artists

will receive half of the honorarium upon delivery of the artwork to the site for installation, inspection and acceptance by the City; and the second half of the payment after de-installation at the conclusion of the three-year exhibition period.

Exhibit A (Peter Walker and Partners Art Master Plan map)

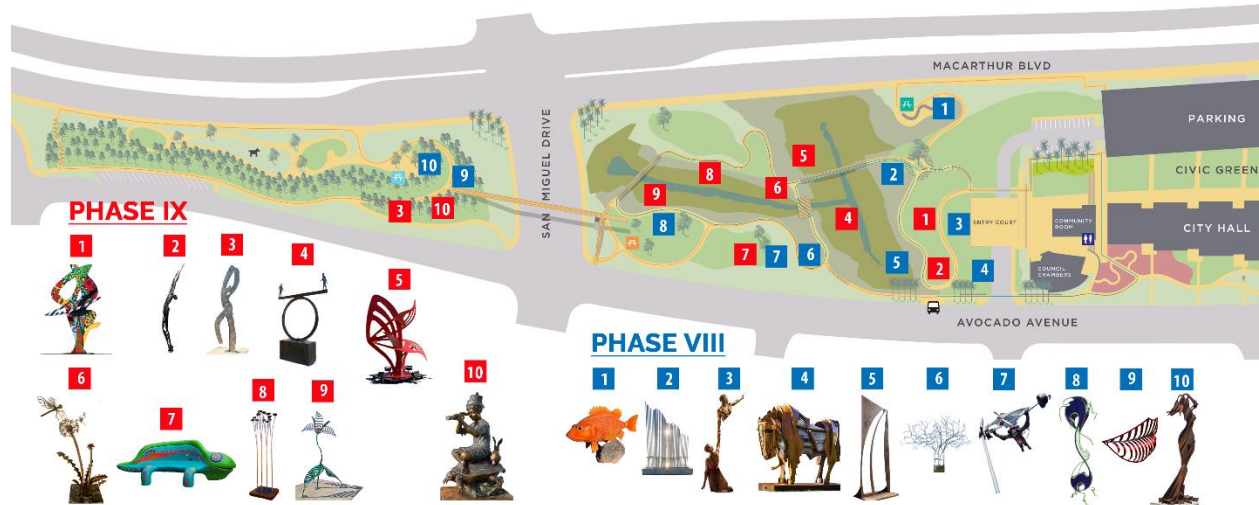

ABOUT THE EXHIBITION:

The exhibition will locate up to ten (10) sculptures throughout the 14-acre Civic Center Park. Selected artworks will remain on display for approximately two years with installation planned in June 2026 and de-installation scheduled for June 2029, sharing the Park with the 10 Phase IX sculptures until those are uninstalled in June 2026.

Artworks may be available for purchase during the exhibition period. **Artists who wish to make their artwork available for sale agree that their piece shall not be de-installed until the conclusion of the exhibition period.** The City of Newport Beach will not request a commission from the sale of artwork, nor will it act as an agent for artist sales.

The Newport Beach Arts Commission will host an opening reception luncheon for the exhibition to take place at a date to be determined. Participating artists are encouraged, though not required, to attend. Exhibited artists will also be invited to talk about their work with visitors during the opening event

if they are in attendance. The City plans to distribute information about the exhibition to the news media, to conduct tours, and to create a self-guided smartphone audio tour. Participating artists may, for promotional usage, submit brief explanatory statements about their artwork, in writing, and participate in audio recording sessions for self-guided tours and educational activities, as possible.

Please Note: To preserve the validity and integrity of the selection process, no applicant may contact any member of the selection committee, City Arts Commission, or the City Council until the entire process is complete, and the City Council has rendered its decision. All decisions are final.

QUESTIONS:

Please direct all questions to Nicholas Thurkettle, Program Coordinator, ArtsOC. (714) 556-5160 x 14 or nthurkettle@artsoc.org
